



Tamarack Nature Center

Backyard Bunch

2018 Newsletter

Welcome to Tamarack...

Communication

We want summer camp to be a great experience for everyone. Please make sure we have your current email and phone numbers (cell, work, home) so we can reach you in case of emergency. Please let us know if your child:

- Has a severe allergy. Please download and complete the *Epinephrine and Benadryl Medication Order and Consent Form* 2 weeks prior to first camp start date.
- Has any particular fears, allergies or physical limitations that would affect his/her experience.
- Will be carpooling with another family or will be picked up by someone else.
- Has recently stopped taking medication that would affect his/her behavior.
- Is on any medication we should know about.
- Potty-trained with the exception of helpful reminders

We will make every effort to inform you of your child's activities at camp and please do not hesitate to come to us with any concerns or questions.

Drop Off and Pick Up

Check-in/out: Parents are required to check-in and check-out each child every day. The Backyard Bunch officially starts at 9:30 am. Check in/out is located in the My Nature Preschool play area on the right wing (north end) of the building.

Drop off & Pick up Times: Staff cannot accommodate children arriving early or being picked up late, Please be courteous and drop off/pick up your child according to the scheduled hours of the program. This camp is designed with the busy family in mind with semi-flexible drop offs /pickups:

- Drop off between 9:30 am up to 10:15 am.
- Snack is at 10:30 am, please pack your child a healthy snack so they have sustained energy throughout the morning.
- Pick up between 11:15-12pm.
- Lunch Bunch is a free add on, offered 12-12:30p, If participating, please pack your child a lunch, and indicate at drop off.

Lunch Bunch: Lunch Bunch is an optional part of the Backyard Bunch for your busy family. If you know that you need extra time that morning and want your child to eat at camp before pick up, please pack a lunch in addition to the small snack. Last pick up is at 12:30 pm.

Check the Lunch box at check-in.

Parking: Park in the front parking lot nearest to the North end of the building. Walk your child to the designated camp on the side of the building by the preschool outdoor play area. We appreciate your cooperation.

Activities

All activities are child-centered, child-led unstructured play. What does that mean? The thought behind the concept of nature play stems from encompassing the knowledge of the natural world through the eyes of a child's sense of wonder, appreciation for the beauty & mystery of the natural world along with the opportunities to experience being close to nature.

As naturalist, we set the stage with loose parts, and the play space that will enhance the theme of the day. From there the kids learn through play!



Lunch and Snacks

Due to the increasing frequency and potential severity of peanut/nut allergies, **please avoid sending any peanut/nut related food items.** We ask that you send food and beverages in a travel safe and insulated container marked with your child's name. Supervision during snack and lunch is provided. Refrigerated storage space is not available.

Snack— snack break begins at 10:30 am. Please bring a healthy snack for your child so they can have energy all morning.

Lunch Bunch – If you are choosing to have your child stay past the end of program and be a part of the Lunch Bunch, please send a substantial lunch, healthy snacks and beverages to keep their energy level high.



Tamarack Director, Marcie Oltman, ext. 110
Camp Coordinator, Megan Nysse, ext. 102
Backyard Bunch Coordinator, Heidi Faris ext. 126

5287 Otter Lake Road
White Bear Township, MN 55110
phone: (651) 407-5350 fax: (651) 407-5354
www.tamaracknaturecenter.org
tamarack@co.ramsey.mn.us

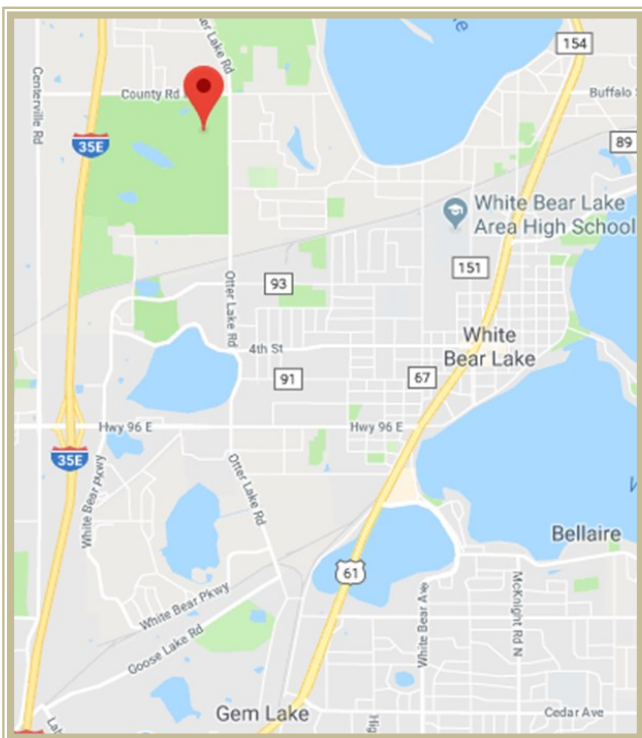

What to Bring to Camp Each Day

Please mark all belongings with your child's full name and send along in a backpack or bag each day.

- Healthy snack and beverage. Additionally lunch, if you are staying for a Lunch Bunch
- Refillable water bottle (filled with water)
- Hat to protect from sun and insects
- Light jacket for cool mornings
- Extra set of clothing including shoes along with closed-toe shoes (no flip-flops)
- Rain gear, if necessary
- Sunscreen, wipes or lotion (no spray)
- Insect repellent, wipes or lotion (no spray)

All items of sentimental or monetary value (including toys) should be left at home.

Insect Repellent/Sunscreen

Please apply insect repellent and sunscreen to your child each day before camp. Please mark your repellent/sunscreen with your child's name (wipes or lotion - no spray). As an extra precaution, we recommend you check your child for ticks every day after camp.

Camp T-shirts Available

Tamarack Nature Center Summer Camp T-shirts are available in youth and adult sizes in multiple colors. Show your camp spirit by purchasing a T-shirt from the reception desk for only \$15.

Weather

Nature never stops, so during light rain or wind, activities will continue. During severe weather, children will be moved to a safe location. Children should be dressed in appropriate gear for outdoor fun!

On days when the heat and humidity are high, we bring out the sprinklers, hoses and the slip-n-slide for some old-fashioned summertime fun. We watch the weather forecast and let you know when to send along a towel, swimsuit or extra clothes.

In case of severe weather, children will be moved to the Forest Room of My Nature Preschool inside the building.

**Voted Best Summer Camp by
Sun Focus Readers
Three Years in a Row!**

**A Facility of
RAMSEY COUNTY**